



2
←

Emerson Rd

Existing Driveway

416.7

435.11

641.55

60'

PROPOSED
MULTI PURPOSE
BUILDING

100'

140'

10'

112'

CONC.

EXISTING
SCHOOL

CONC.

182.37

78.28

219.95

□
Exst.
WZII
House

1" = 50'

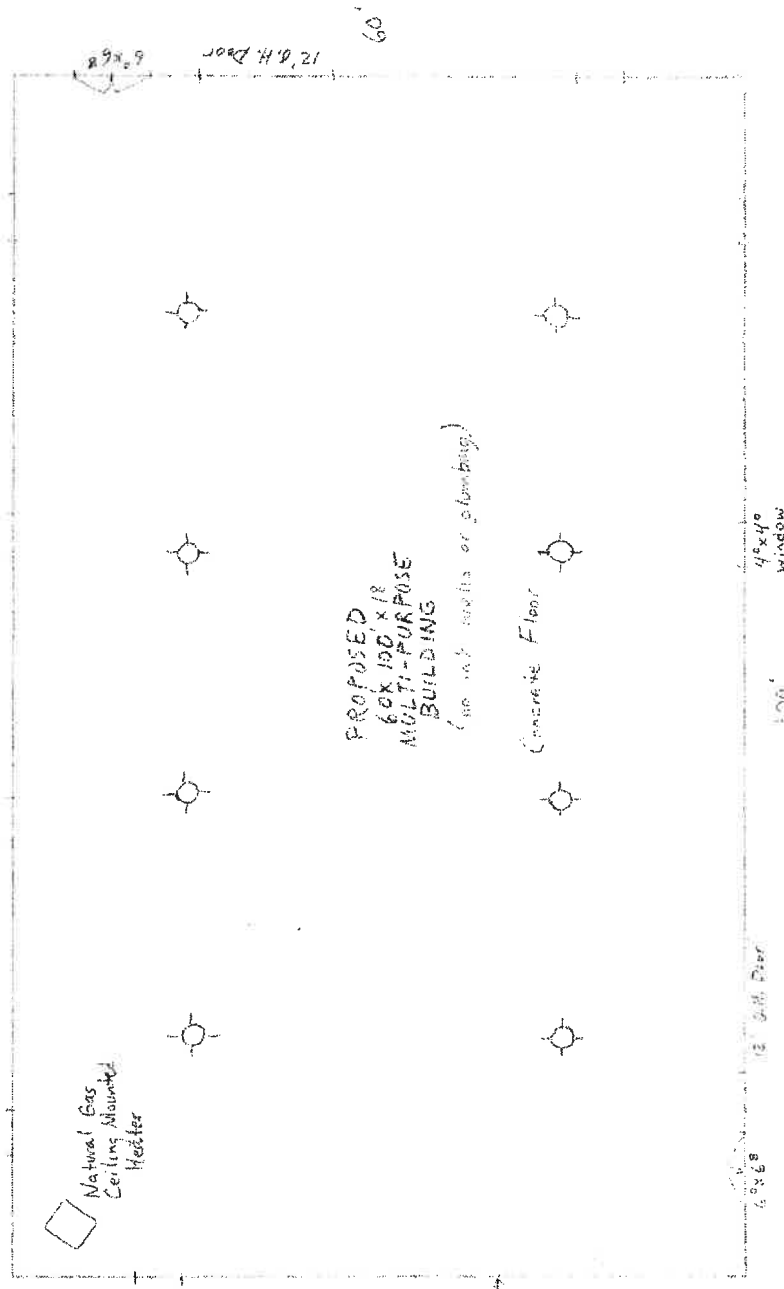

PROPOSED
60' x 100' x 12'
MULTI-PURPOSE
BUILDING
(no int. walls or columns)

Natural Gas
Ceiling Mounted
Heater

Concrete Floor

4' x 4'
Window

12' 6.4' Door

EXISTING
SCHOOL
BLDG

1061 EMERSON S.D.
PROPOSED MULTI-PURPOSE BLDG.
1" = 10'